

Flexibele Reductie Coup

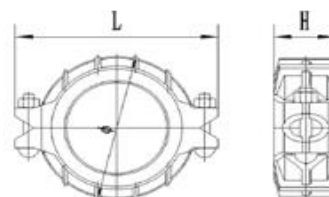

Normal Size in mm	Normal Size inches	Pipe O.D. in mm	Pipe O.D. inch	Working Pressure Bar/PSI	Bolt Size No-Size in mm	Ø
50x40	2x1½"	60,3x48,3	2.375x1.900"	20,7/300	2-M10x55	90-3.543"
65x40	2½x1½"	73,0x48,3	2.874x1.900"	20,7/300	2-M10x55	101-3,976"
65x50	2½x2"	73,0-60,3	2.874x2.375"	20,7/300	2-M10x55	101-3,976"
65x40	2½x1½"	76,1-48,3	2.996x1.900"	20,7/300	2-M10x55	105-4.134"
65x50	2½x2"	76,1x60,3	2.996x2.375"	20,7/300	2-M10x55	120-4.724"
80x40	3x1½"	88,9x48,3	3.500x1,900"	20,7/300	2-M12x65	120-4.724"
80x50	3x2"	88,9x60,3	3.500x2.375"	20,7/300	2-M12x65	120-4.724"
80x65	3x2½"	88,9x73,0	3.500x2.874"	20,7/300	2-M12x65	120-4.724"
80x65	3x2½"	88,9x76,1	3,500x2.996"	20,7/300	2-M12x65	120-4.724"
100x40	4x1½"	114,3x48,3	4.500x1.900"	20,7/300	2-M12x65	150-5.906"
100x50	4x2"	114,3x60,3	4.500x2.375"	20,7/300	2-M12x65	150-5.906"
100x65	4x2½"	114,3x73,0	4.500x2.874"	20,7/300	2-M12x65	150-5.906"
100x65	4x2½"	114,3x76,1	4.500x2.996"	20,7/300	2-M12x65	150-5.906"
100x80	4x3"	114,3x88,9	4.500x3.500"	20,7/300	2-M12x65	253-9.961"
150x100	6x4"	165,1x114,3	6.500x4.500"	20,7/300	2-M12x75	203-7.992"
150x80	6x3"	168,3x88,9	6.625x3.500"	20,7/300	2-M12x75	203-7.992"
150x100	6x4"	168,3x114,3	6.625x4.500"	20,7/300	2-M12x75	203-7.992"
200x150	8x6"	219,1x168,3	8.625x6.625"	20,7/300	2-M16x100	264-10.394"

--	--

Dimension in mm	
--------------------	--

length	height
129-5.079"	47-1.850"
137-5.393"	48-1.889"
137-5.393"	48-1.889"
140-5,512"	48-1.889"
140-5,512"	48-1.889"
164-6.457"	48-1.889"
164-6.457"	48-1.889"
164-6.457"	48-1.889"
164-6.457"	48-1.889"
195-7.677"	49-1,929"
195-7.677"	49-1,929"
195-7.677"	49-1,929"
195-7.677"	49-1,929"
195-7.677"	49-1,929"
235-9.252"	50-1.969"
235-9.252"	50-1.969"
235-9.252"	50-1.969"
313-12.323"	60-2.362"